

Features:

- ◆ Maintenance-free operation
- ◆ Stable quality and high reliability
- ◆ Compact design
- ◆ 5 years design time (at 25°C)



Applications

- ◆ UPS
- ◆ Emergency lighting
- ◆ Fire alarm and security systems
- ◆ Telecommunication system
- ◆ Backup power for testing and measuring instruments
- ◆ Alarm and security system
- ◆ Electronic apparatus and equipment
- ◆ Communication power supply
- ◆ DC power supply
- ◆ Auto control system

Specifications

Nominal Voltage	12V(6cells) 2.2AH (20hr,1.75V/cell,25°C/77°F)	Operating Temp Range	Discharge: -15—50°C(5—122°F) Charge : 0—40°C(32—104°F)
Nominal Capacity	1.95AH(5hr,1.75V/cell,25°C/77°F) 1.38AH(1hr,1.60V/cell,25°C/77°F)	Nominal Operating Temp. Range	Storage : -15—40°C(5—104°F) 25±3°C(77±5°F)
Dimension	Length 178±1mm	Cycle Use	14.4~14.8V(25°C/77°F)Temp.Coefficient-30mV/°C Initial Charging Current Less than 0.69A
	Width 34±1mm	Standby Use	13.5V~13.8V(25°C/77°F)Temp.Coefficient-20mV/°C No limit on Initial Charging Current
	Container Height 60±2mm		40°C(104°F) 103%
	Total Height(with Terminal) 65±2mm	Capacity affected by Temperature	25°C(77°F) 100%
Weight 845G ±3%		0°C(32°F) 86%	Self Discharge CASIL CA series batteries may be stored for up to 6months at 25°C(77°F)and then a freshening charge is required. For higher temperatures the time interval will be shorter.
Terminal F1			
Container Material ABS UL94 V0			
Max.Discharge Current 33 A(5S)			
Internal Resistance Approx 75mΩ			

Constant Current Discharge (Amperes at 25°C / 77 °F)

F.V/Time	5min	10min	15min	30min	45min	1h	3h	4h	5h	6h	8h	10h	20h
1.60V	7.4	5.8	3.9	2.2	1.8	1.38	0.6	0.48	0.41	0.36	0.31	0.215	0.120
1.67V	7.2	5.6	3.8	2.1	1.80	1.35	0.6	0.47	0.40	0.36	0.31	0.213	0.118
1.70V	7.1	5.5	3.8	2.1	1.77	1.33	0.6	0.47	0.40	0.35	0.30	0.211	0.117
1.75V	6.9	5.4	3.7	2.0	1.73	1.30	0.58	0.46	0.39	0.35	0.30	0.207	0.11
1.80V	6.8	5.3	3.6	2.0	1.70	1.27	0.56	0.45	0.38	0.34	0.29	0.203	0.113

Constant Power Discharge (Watts per cell at 25°C / 77 °F)

F.V/Time	5min	10min	15min	30min	45min	1h	3h	4h	5h	6h	8h	10h	20h
1.60V	13.2	10.4	7.0	3.9	3.5	2.6	1.20	0.96	0.81	0.72	0.62	0.43	0.239
1.67V	13.0	10.1	6.9	3.8	3.4	2.6	1.18	0.95	0.81	0.71	0.62	0.43	0.237
1.70V	12.7	9.9	6.8	3.7	3.4	2.5	1.17	0.94	0.80	0.70	0.61	0.42	0.235
1.75V	12.5	9.7	6.6	3.7	3.3	2.5	1.15	0.92	0.78	0.69	0.60	0.41	0.230
1.80V	12.2	9.5	6.5	3.6	3.2	2.4	1.13	0.90	0.77	0.68	0.59	0.41	0.225

Note: The above characteristics data are average values obtained within three charge/discharge cycles, not the minimum values.

Dimensions

Terminal

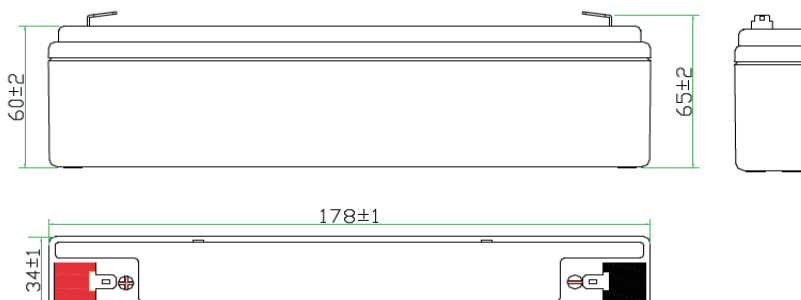
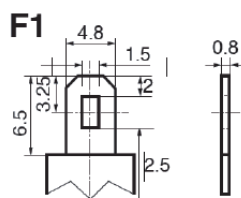

Storage characteristics

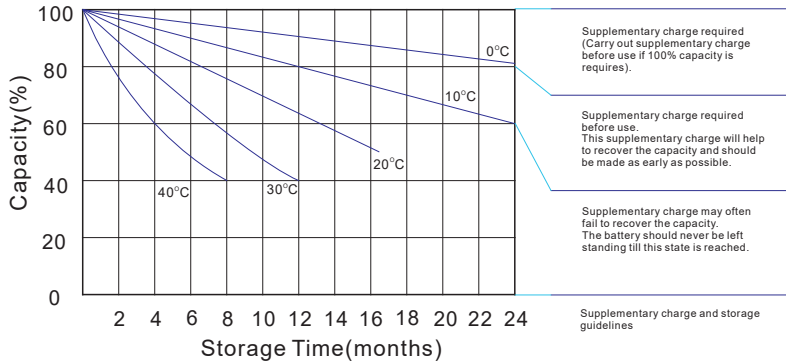

Effect of temperature on long term float life

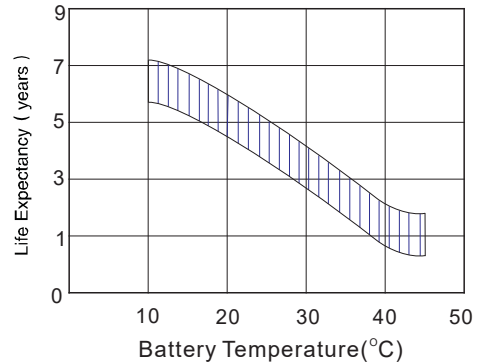

Charge characteristic Curve for standby use

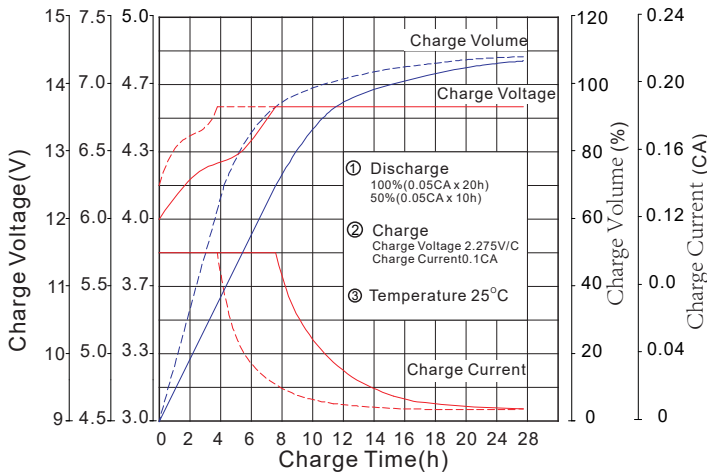

Cycle Life in Relation to Depth of Discharge

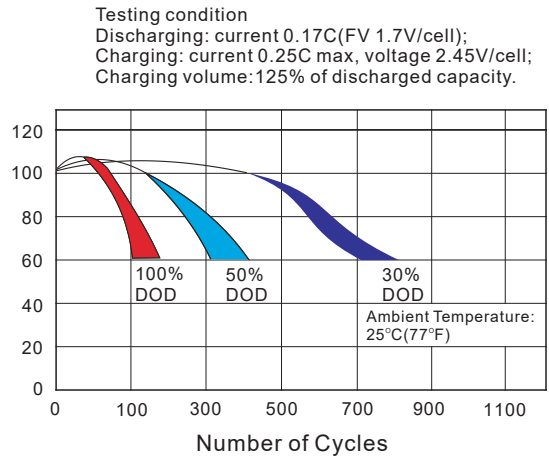

Discharge characteristic Curve

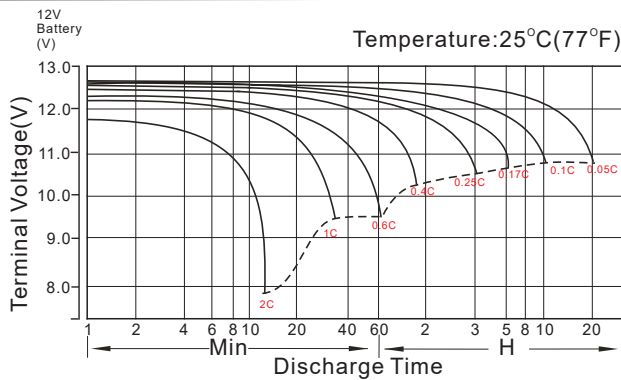

Temperature Effects in Relation to Battery Capacity

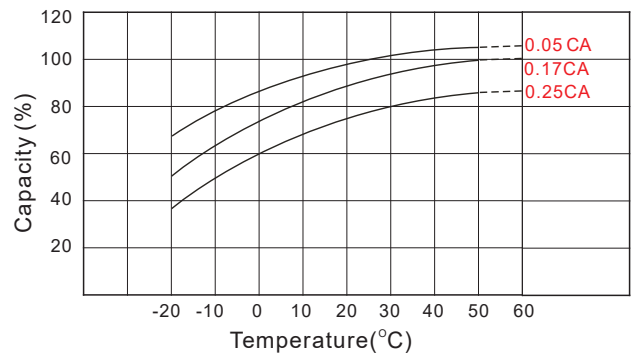

This information is generally descriptive only and is not intended to make or imply any representation, guarantee or warranty with respect to any cells and batteries. Cell and battery designs/specifications are subject to modification without notice.